

Floorplans

# Great Stair Hall

**Maximum Capacity**

Reception: 600

Dinner: 140

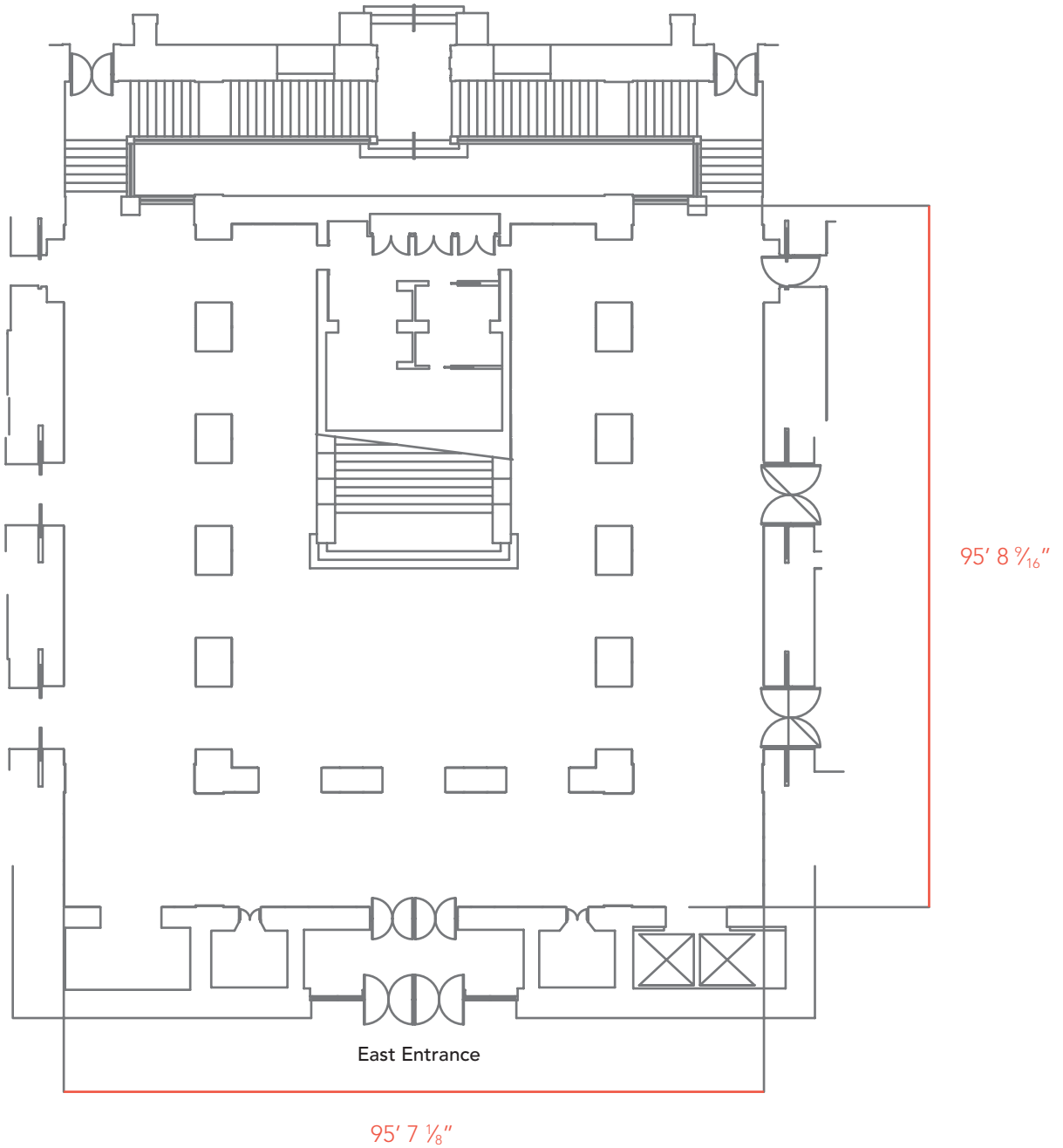

Special Events  
215-684-7310  
[entertaining@philamuseum.org](mailto:entertaining@philamuseum.org)  
[philamuseum.org/entertaining](http://philamuseum.org/entertaining)

1015-8209

Philadelphia  
Museum of  
**Art**

**Floorplans**

# Great Stair Hall Balcony

**Maximum Capacity**

Reception: 600

Dinner: 380

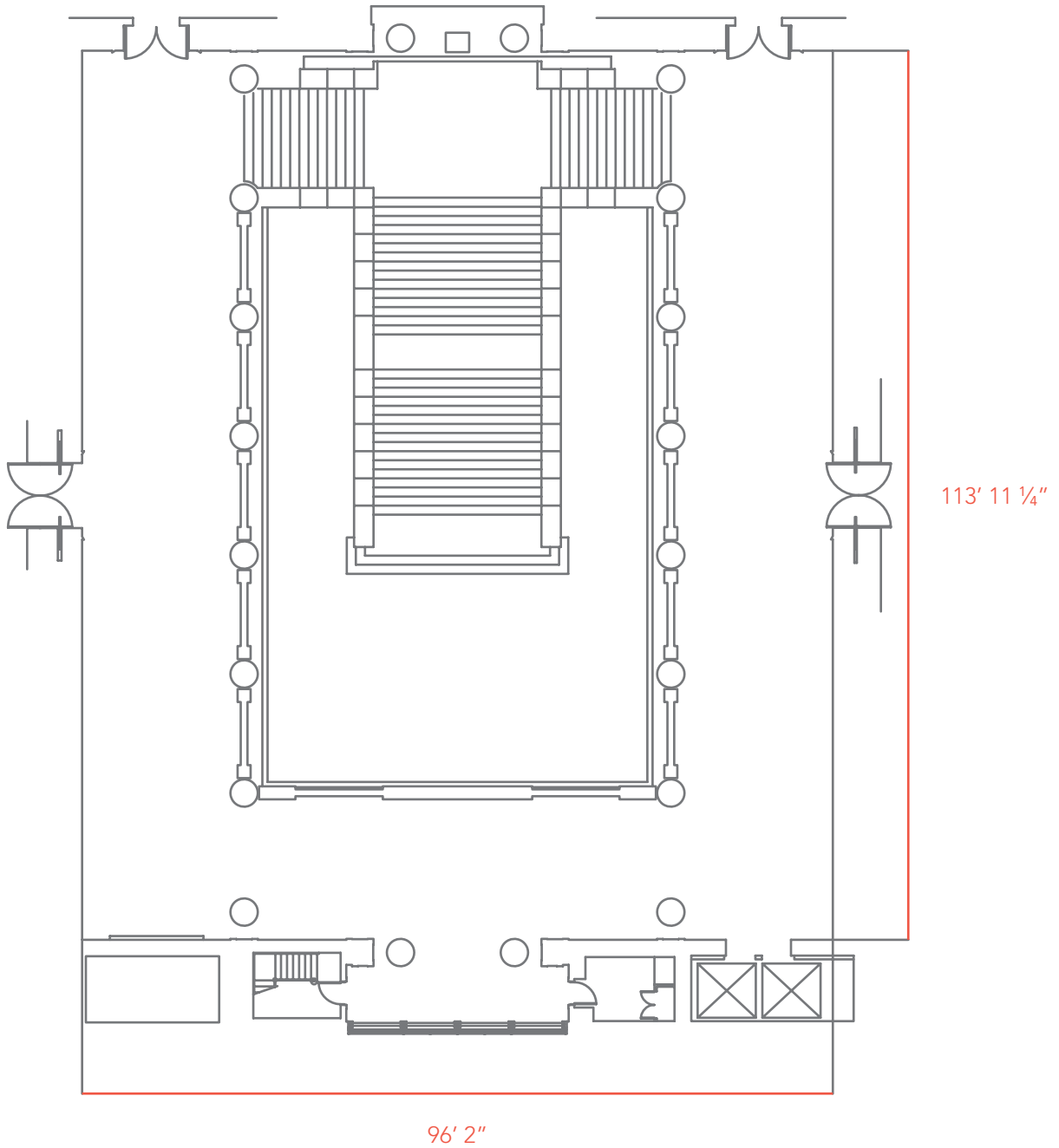

Special Events  
215-684-7310  
entertaining@philamuseum.org  
philamuseum.org/entertaining

1015-8209

**Floorplans**

# Saint-Genis-des-Fontaines Cloister and Saint-Laurent Gallery

**Maximum Capacity**

Reception: 125

Dinner: 100

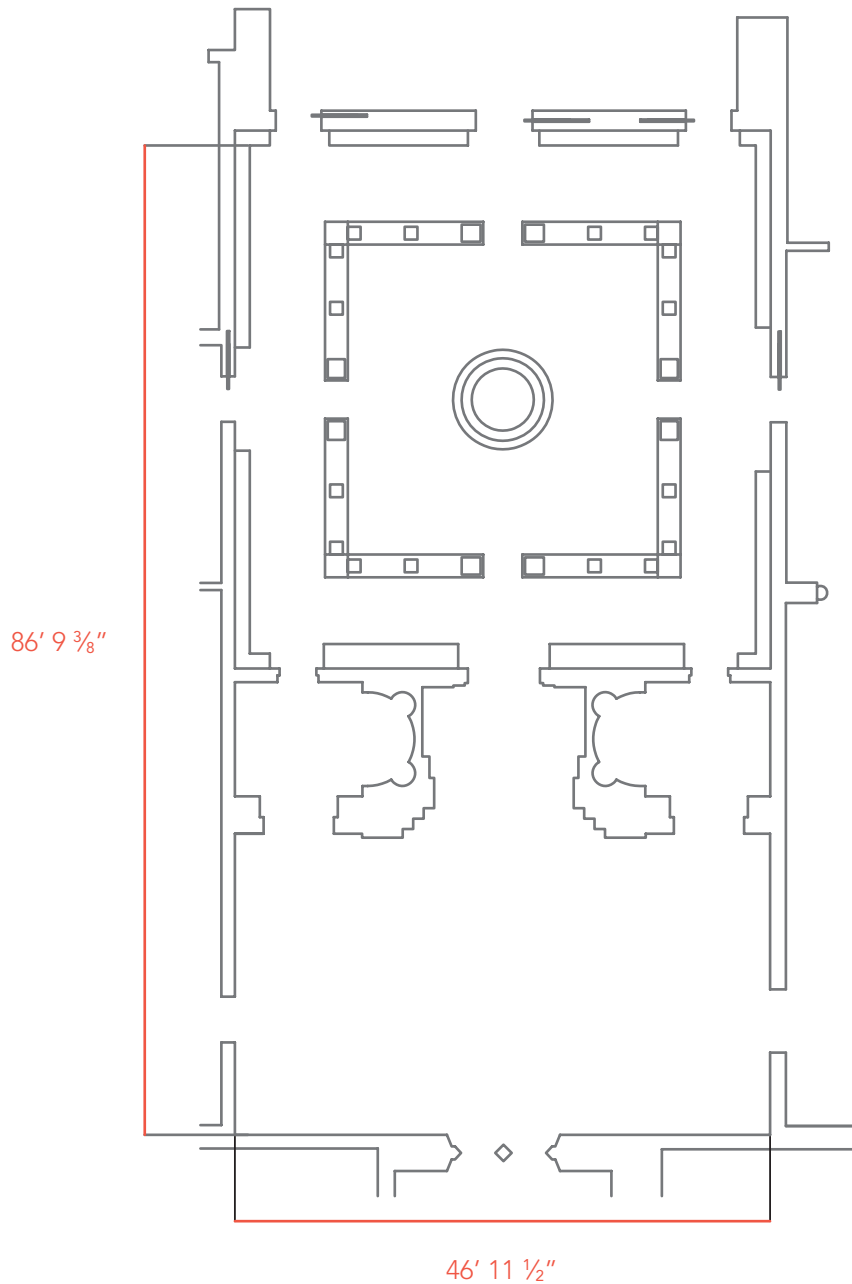

**Special Events**

215-684-7310

[entertaining@philamuseum.org](mailto:entertaining@philamuseum.org)

[philamuseum.org/entertaining](http://philamuseum.org/entertaining)

1015-8209

**Floorplans**

# East Terrace

**Maximum Capacity**

Reception: 2,000 and up

Dinner: 1,400

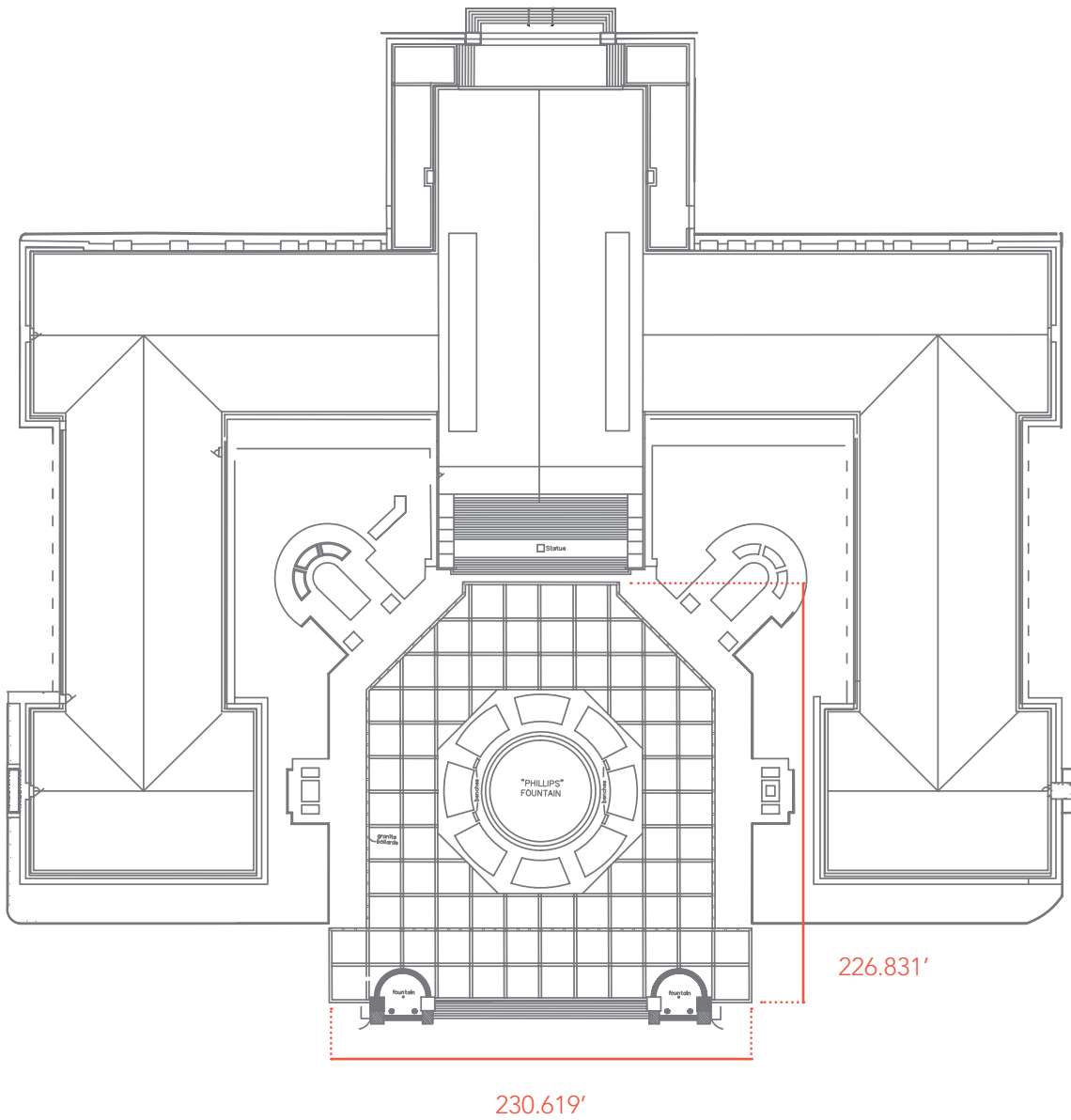

**Special Events**

215-684-7310

[entertaining@philamuseum.org](mailto:entertaining@philamuseum.org)

[philamuseum.org/entertaining](http://philamuseum.org/entertaining)

1015-8209

Floorplans

# Balcony Café

Maximum Capacity  
Reception: 50

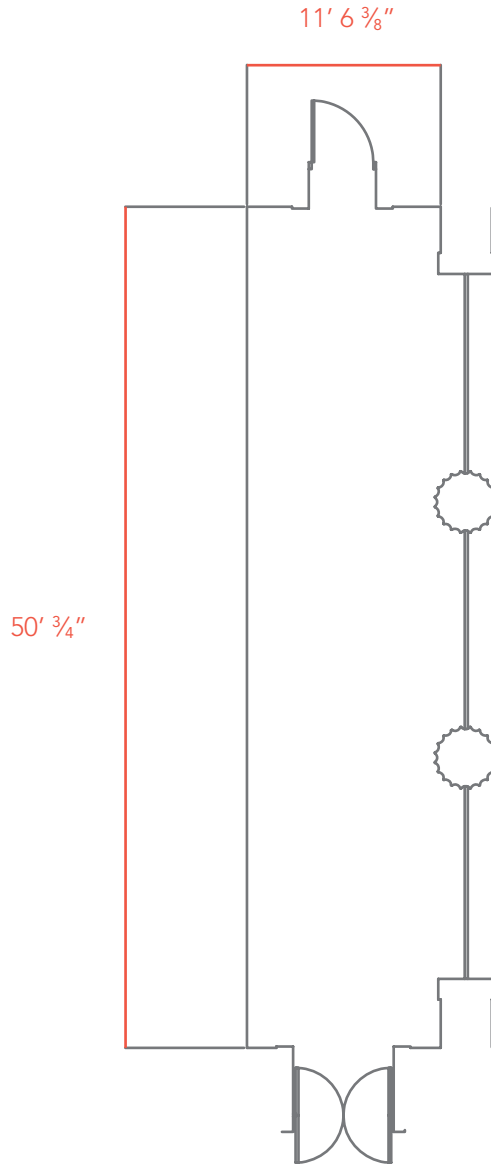

**Floorplans**

# Stir

**Maximum Capacity**  
Seated dinner: 76

